

光纤滑环采用光纤为数据传输媒体,为设备旋转部位连接信号和数据提供可靠传输,提供最佳解决方案.

FORJ是标准的单模单通道光纤滑环系列,坚固耐用的主体可选择甩尾纤、尾纤加FC/PC接头或者直接接ST、Fc等接头配置连接. R系列具有极低的插入损耗,光纤滑环环境适应性强,可以在北极温度下运作(见图表里插入损耗和回波损耗、温度).所有型号适应灰尘和水等恶劣环境使用.可选压力补偿应用模型, RPTPC浅水可用. FORJ系列因波长和接口不同分为:RFC、RST、RPTA、RPTPC等几款基本型号,其它型号请联系我们:

The series Single-channel (SM or MM)rotary joints are the most versatile designs the market has ever seen . The rugged body alloes fiber pigtail,ST orFC receptacles on either the rotor side or the stator side. One can configure the RPT RFC and FST for pigtails,FC/PC,and ST/PC receptaclesThe R series features extremely low insertion loss and impressive return loss pefomance for bothsinglemode and multimide fibers.Model RPTA guarantees return loss as high as 50dB ,These rugged devices can operate undet arctic temperature environment (see insertion loss and return losstemperature cycling plots on the left).Allmodels are dust and water tight for harsh environment.Optional pressure compensation is available with model RFTPC for shallow water applications

### TS系列编码简示

产品代码

系列代码

PSR - FORJ - RST

光纤/接口代码  
FC、PAT、SC、SMA  
可选择接口

波长代码

### 典型应用 Typical Application

军事 雷达/Military Radar  
风力发电 海洋应用/Wind Energy Marine  
航空 航天精密旋转设备/Aerospace Military Rotor tester  
医疗设备 精密仪器/Medical equipment precision instrumen



### 性能规格 Performance specifications

工作波长 Wavelength	1310nm
插入损耗 Insertion Loss	<2 dB
回波损耗 Return Loss	>40 dB
回波损耗 Return loss	-18 dB / 1GHz Max
最大转速 Maximum Speed	2,000rpm
压力补偿 Pressure Compensation	
拉拔强度 Drawing strengths	10N
预计寿命 Estimated life cycle	200million R
光波功率 Light power	23Dbm
工作温度 Operating Temperature	-40 to 85 °C
储存温度 Storage temperature	-40 to 85 °C
光纤类型 Fiber Type	FC
接头类型 Connector Type	Single mode w/3 mm jacke
尾纤长度 Pigtail Length	2m

光纤滑环 Fiber Rotary joint

基本型号及接口 Basic Model and Size

外径 Outerdia	Circuits	55mm
基本型号 Model No.	接口	长度L Length "L"
PSR-FORJ-RST	ST	33.8mm
PSR-FORJ-RFC	FC	47.6mm
PSR-FORJ-RSC	SC	61.4mm
PSR-FORJ-RLC	LC	75.2mm

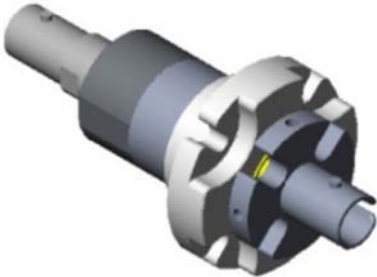

外形尺寸图 Dimensions

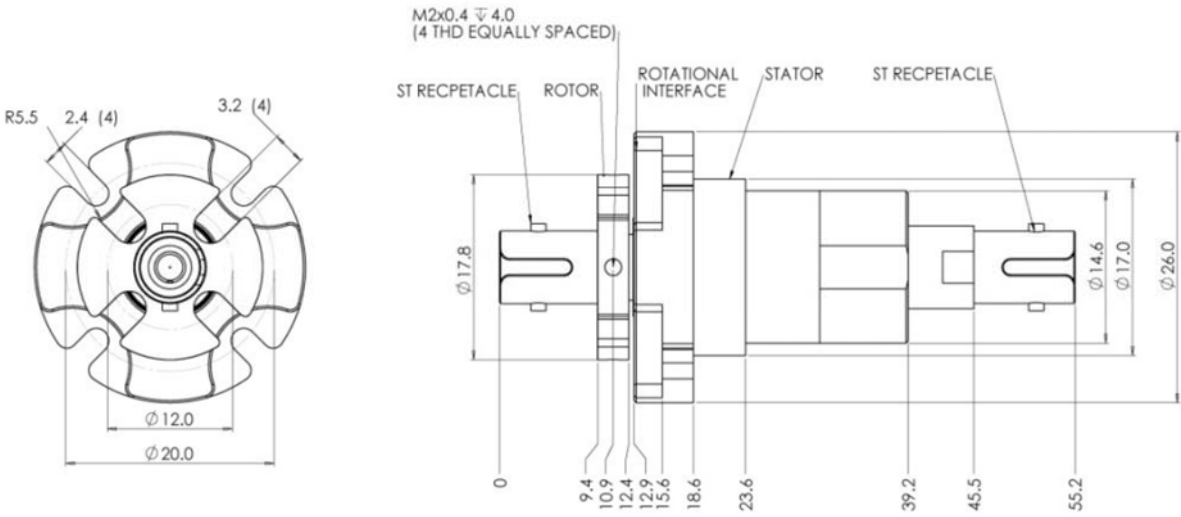

外形尺寸图 Dimensions

